



Georgia Department of Transportation



• ECONOMIC IMPACT REPORT FOR •
BURKE COUNTY AIRPORT



September 2020

According to Site Selection Magazine, Georgia is **ranked as the #1 state for doing business.**

Georgia Airports Mean Business.

Airports in Georgia generate positive economic impacts as well as support many other sectors of local and state economies. In the summer of 2019, the Georgia Department of Transportation undertook a statewide study to estimate the annual economic impact of 102 study airports. The study estimated economic impacts for seven commercial airports and 95 general aviation airports. This report includes impacts related to **Burke County Airport** and summarizes all Statewide Airport Economic Impacts.

Annual Economic Impacts for Burke County Airport

Residents, businesses, and visitors benefit from the state's well-developed airport system. While supporting transportation, healthcare, tourism, and commerce, airports contribute to the economy. The Economic Impact Study identified specific economic impacts associated with the **Burke County Airport** and other airport benefits. Key impacts for the **Burke County Airport** follow.

- Annual Visitors **1,508**
- Employment Supported **23**
- Annual Payroll **\$834,200**
- Annual Spending **\$2,084,900**
- Annual Economic Impact **\$2,919,100**
- Airport-Supported Annual State & Local Sales & Income Tax Revenues **\$102,150**

Economic Impacts for Burke County Airport

The table below provides information on the sources of annual economic impact estimated for the **Burke County Airport**. For more information on the impacts reported here, consult the study's Technical Report available at dot.ga.gov/IS/AirportAid.

Annual Economic Impacts for Burke County Airport

| | Employment | Payroll | Spending | Total Economic Activity |
|---------------------------------------|------------|------------------|--------------------|-------------------------|
| Airport Management & Business Tenants | 9 | \$415,400 | \$520,000 | \$935,400 |
| Capital Investment | 12 | \$359,900 | \$1,473,500 | \$1,833,400 |
| General Aviation Visitor Expenditures | 2 | \$58,900 | \$91,400 | \$150,300 |
| Total | 23 | \$834,200 | \$2,084,900 | \$2,919,100 |

Georgia Airports Support Connectivity

A flight from a Georgia airport is a gateway to over 40,000 worldwide airports, including over 19,000 airports in the US alone. When employers seek to relocate or expand, proximity to an airport is among the top 10 factors they consider in their decision making. Georgia's tourist industry also depends on the efficiency of air travel.

This map depicts destinations for flights departing from and arriving at **Burke County Airport** on any given day. This information is generated from the FAA's National Offload Program (NOP). Flights represent only a fraction of all destinations that can be reached directly from the airport. The map helps to show how the airport supports the travel needs of businesses, visitors, and residents of the airport's service area.



Top Five Destinations for Burke County Airport

- 1** Columbus, Georgia
- 2** Winder, Georgia
- 3** Jacksonville, Florida
- 4** Thomson, Georgia
- 5** Atlanta, Georgia

Statewide Economic Impacts

Shown below are total annual statewide economic impacts. All economic impacts shown in this report for Hartsfield-Jackson Atlanta International Airport were obtained from a separate study for that airport conducted by the City of Atlanta. As shown, when all Georgia airports are considered, total annual statewide economic impacts are estimated at 450,502 jobs, \$9.2 billion in annual payroll, and \$73.7 billion in annual economic activity.

Statewide Economic Impacts All System Airports

| | Hartsfield-Jackson Atlanta International Airport* | Commercial Study Airports | General Aviation Study Airports | State Total |
|-------------------|---|---------------------------|---------------------------------|----------------|
| Employment | 383,242 | 52,376 | 14,893 | 450,502 |
| Payroll | \$16.7 billion | \$1.3 billion | \$271 million | \$9.2 billion |
| Economic Activity | \$66.8 billion | \$2.2 billion | \$828 million | \$73.7 billion |

*2016-2017 Technical Report, City of Atlanta Economic Impact Study

Economic Impact Categories and Measurements

The study identified impacts related to airport management (day-to-day airport operations), aviation-related business tenants, average annual capital investment, expenditures by visitors arriving on general aviation aircraft, and expenditures by visitors arriving on scheduled commercial airline flights. For each of these five categories, impacts were measured for **employment, payroll, spending, and annual economic activity**. Annual economic activity is the sum of payroll and spending. In addition, the study estimated state and local tax revenues that are generated by airport-supported activities.

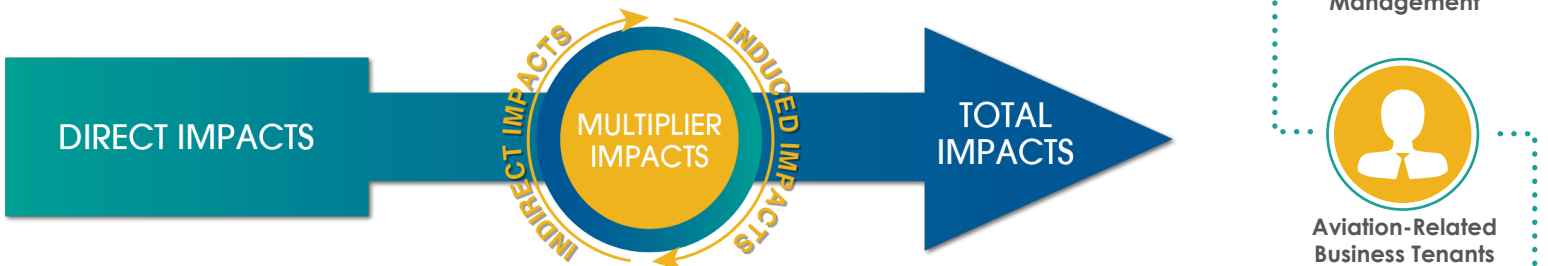

Study Methodology

Data collection and survey efforts identified **direct** economic impacts in each of the five impact categories using an approved FAA methodology. A state input/output model (**IMPLAN**) was used to estimate additional **indirect and induced** impacts, sometimes referred to as multiplier impacts. Combined, direct plus indirect/induced impacts equal total state or airport specific economic impacts.

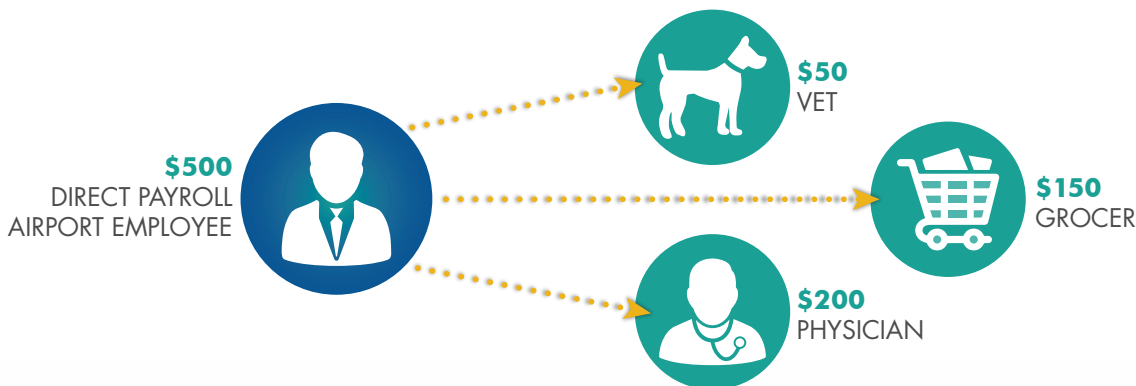

The direct impacts that start at the airport multiply within the state economy. The \$150 of direct impact spent with the grocery results in additional payroll (induced impacts) for the grocer's employees. As the grocery buys supplies, this additional business to business spending results in indirect impacts.

Visitors Arriving on Commercial Flights

Burke County Airport

The Burke County Airport is located in Burke County in the eastern part of Georgia. The airport is approximately 30 miles south of Augusta and 40 miles northeast of Swainsboro. Primary highway access to the airport from the north and south is via U.S. Highway 25 and Georgia Highway 21. Other highways in the vicinity of the airport include Georgia Highways 56, 24, and 80. There are approximately 45,000 residents within a 30-minute drive of the airport.

The airport is owned and operated by Burke County. The airport is served by a single runway, Runway 8/26, which was recently extended to 5,000 feet. McMillan AG Services is the airport's single business tenant. They provide aerial application services to area agricultural interests.

The airport accommodates a variety of aviation-related activities including recreational flying, agricultural spraying, corporate/business jets, and ultra-lights.

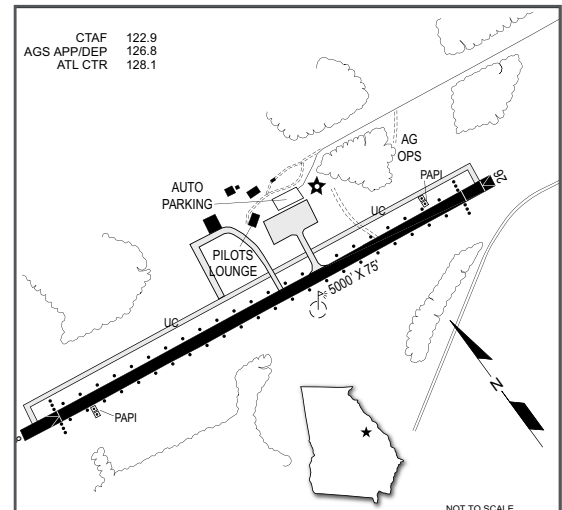

Examples of How Burke County Airport Supports its Community

There is a good chance you benefit from different activities that the airport supports. Airports support healthcare and emergency services. Airports support the state's agricultural and forestry industries, and power companies rely on airports to keep electricity flowing. State and federal agencies use airports to protect the environment, and law enforcement benefits from airports. Businesses throughout Georgia rely on airports to improve their efficiency. Examples of how the airport benefits the community follow.

Business Use: Airports are important tools used by a wide variety of employers to increase their efficiency. When businesses consider where they locate or expand, proximity to an airport is often a top consideration. Airports are also an important contributor to an area's economic diversification and growth. Both local and visiting businesses rely on air travel to increase their efficiency. Airports can be used to help companies expand their market areas, reduce employee travel time, provide access for customers and suppliers, and tie together offices in multiple locations. Local businesses rely on and benefit from the airport. CMS is headquartered in Fisciano, Italy; they recently begin operations in Waynesboro, producing stainless steel fuel tanks for MAGNA and BMW. The company's initial investment of around \$12 million created 27 new local jobs. Ingevity provides specialty chemicals, high-performance, carbon material, and engineered polymers. Their products are used in asphalt paving; oil exploration and production, agrochemical, adhesives, lubricants, and automotive components. Ingevity operates from 25 locations around the world, including their location in Waynesboro, and employs 1,850 people around the world. The airport supports these and other local businesses.

Aerial Applicators: Over 25 million acres, two-thirds of the state, are forested. According to the Georgia Forestry Commission (GFC), annual economic activity generated by the state's forest industry is estimated at \$36.2 billion. Agriculture and forestry have long been an important part of Georgia's economy. Georgia is home to a diverse array of food and fiber/timber products and an assortment of related processing companies. Together, agriculture and forestry and their related industries in Georgia directly and indirectly account for over \$74.3 billion in economic output. McMillan Custom Service is an example of a Burke County Airport-based aerial applicator that has served local agricultural interests for over 40 years. The Airport Commission supports the use of aircraft in support of farming and fully understands the need for transient aircraft to serve the needs of area agricultural and forestry production.

Military Use: While Georgia and the Southeast have several military air bases. Even with these facilities, civilian airports in Georgia play an important role in supporting military operations. According to study research, both the U.S. Army and Air Force use the airport to support their operations. Most often, when military aircraft operate at civilian airports, they are performing training exercises. A strong military is important to the U.S. By supporting military operations, the airport helps to contribute to national defense.

Georgia Department of National Resources: The Georgia Department of Natural Resources (DNR) helps to oversee state parks and historic resources, wildlife resources, law enforcement, historic preservation, environmental protection, and coastal resources throughout the state. DNR is supported by an aviation unit that frequently uses the airport to support its missions. DNR's aviation unit flew 960 hours this year to support their missions. Almost 33% of their hours were flown to support the protection the state's waterways and woodland areas. DNR assists other agencies such as the Department of Justice, the Environmental Protection Agency, and the Federal Aviation Administration.

THIS DOCUMENT WAS PREPARED BY

Jviation
900 S Broadway, Suite 350
Denver, Colorado 80209
303.524.3030
www.jviation.com

Data collection and analysis for this study took place before the onset of the COVID-19 pandemic in March 2020. Results reflect conditions at Georgia airports prior to that time.

FOR MORE INFORMATION PLEASE CONTACT

Georgia Department of Transportation Aviation Programs
600 West Peachtree Street NW
Atlanta, Georgia 30308
404.631.1990 | dot.ga.gov/IS/AirportAid
Email: aviationprograms@dot.ga.gov